

Route 310

Updated: December 2011

1972 Description: Minersville Lake State Park

*(A)Approved by the State Road Commission July 28, 1972.

From the parking area at Minersville Lake State Park east to Route 21.

1983 Legislature: Description remains the same.

1985 Legislature: Description remains the same.

1986 Legislature: Description remains the same.

1987 Legislature: Description remains the same.

1988 Legislature: Description remains the same.

1990 Legislature: Description remains the same.

1992 Legislature: Description remains the same.

1993 Legislature: Description remains the same.

1994 Legislature: Description remains the same.

1995 Legislature: Description remains the same.

1996 Legislature: Description remains the same.

1997 Legislature: Description remains the same.

1998 Legislature: Description remains the same.

1999 Legislature: Description remains the same.

2000 Legislature: Description remains the same.

2001 Legislature: Description remains the same.

2002 Legislature: Description remains the same.

2003 Legislature: Description remains the same.

2004 Legislature: Description remains the same.

2005 Legislative Description:

From Route 21 northerly to the parking area at Minersville Lake State Park.

2006 Legislature: Description remains the same.

2007 Legislature: Description remains the same.

2008 Legislature: Description remains the same.

2011 Legislature: Description remains the same.

* Refers to Resolution index page following.

Route 310

COUNTY/VOLUME & RESOLUTION NUMBER

A. Beaver Co. 4/42

DESCRIPTION OF RESOLUTION CHANGE

(A). Addition - Added Minersville Lake State Park Road to State System of Highways.

R E S O L U T I O N

State Route 310

WHEREAS, Section 63-11-20, Utah Code Annotated, 1953, as amended, relates that: "All roads connecting state parks with federal, state or county highways or city streets where the title thereto is in the state are parts of the state highway system and are to be maintained by the state. The state road commission is authorized to construct and maintain roads within state parks subject to approval of locations and design by the commission through its director", and

WHEREAS, it is the desire of the Utah State Road Commission and the Utah State Division of Parks and Recreation to define responsibility for the administration of roads at state parks, and

WHEREAS, it is agreed between the State Road Commission and the State Division of Parks and Recreation that certain roads meet the criteria set forth in Section 63-11-20, UCA, 1953, as amended, and

WHEREAS, those roads at state parks that are part of the State System of Highways should be identified by a number.

NOW THEREFORE, in accordance with Section 63-11-20, UCA, 1953, as amended, it is hereby resolved as follows:

That the roadway from the parking area at Minersville Lake State Park east to State Route 21, a distance of 0.34 +- mile, be identified as State Route 310,

That the letter from the Beaver County Commission relating their concurrence in this action be hereby incorporated as a part of this submission,

That the maps attached illustrating the action taken herewith and the location of Minersville Lake State Park be hereby incorporated as a part of this submission.

Dated this 28th day of July, 1972.

STATE ROAD COMMISSION OF UTAH

William H. Church
Chairman

R. G. Hunter
Vice-Chairman

Francis Cottel
Commissioner

Bill H. Hunt
Commissioner

Wayne L. McGinnis
Commissioner

ATTEST:

Ruth A. Manscher
acting Secretary

1777 Koon
Access 6/1

BEAVER COUNTY

State of Utah



Beaver, Utah

GEO. RICHARD JEFFERSON
CHAIRMAN

FRED B. HARRIS
COUNTY COMMISSIONER

THURMAN F. EYRE
COUNTY COMMISSIONER

NICHOLAS R. DOTSON
CLERK AND AUDITOR

RONDO T. FARRER, TREASURER

LOUIS LESSING, RECORDER

MAX LIMB, ASSESSOR

MEL TAIT, SHERIFF

JOHN O. CHRISTIANSEN
ATTORNEY

May 31, 1972

Mr. Blaine J. Kay
State Highway Engineer
Utah State Department of Highways
State Office Building
Salt Lake City, Utah 84114

RECEIVED
JUN 1 1972

Dear Mr. Kay:

The Board of County Commissioners met on May 31, 1972, and discussed your letter of May 19, recommending the access road to the Minersville State Park from State Road 21 become a State Highway.

The Beaver County Commissioners are in full agreement with this proposal and feel it is only proper that this road should become a part of the State Highway System.

Sincerely yours,

Nicholas R. Dotson
N.R.

Nicholas R. Dotson
Beaver County Clerk

By Order of the Beaver County
Commissioners

RECEIVED
Utah State Department of Highways
Transportation Section

JUN 19 1972

AM PM
7,8,9,10,11,12,1,2,3,4,5,6

NRD/hc

COPY OF LETTER RETAINED IN CENTRAL FILES. PUT
THIS ORIGINAL TO CENTRAL FILES AFTER ACTION HAS
BEEN COMPLETED.

| | | | |
|-----------------------|---------|---------------|-------|
| SEARCHED | INDEXED | SERIALIZED | FILED |
| <i>Kay</i> | | | |
| R - Return to Sender | | S - Signature | |
| P - Prepare Reply for | | my Secret. | |

May 19, 1972

G. Richard Jefferson, Chairman
Beaver County Commission
Beaver County Courthouse
Milford, Utah 84713

Subject: Minersville State Park Access

Dear Chairman Jefferson:

In discussions with the Division of Parks and Recreation the State Highway Department has agreed to recommend to the State Road Commission and the Legislature that the access road to the Minersville State Park from State Road 21 become a State Highway if Beaver County agrees to the change. As you are aware this short stub road has been part of the County system and has been maintained by County forces.

If the County is agreeable to having this road shifted to the State Road System please notify us by letter and we will take the necessary action.

Very truly yours,

Blaine J. Kay, P.E.
State Highway Engineer

BdK/HBL/bb

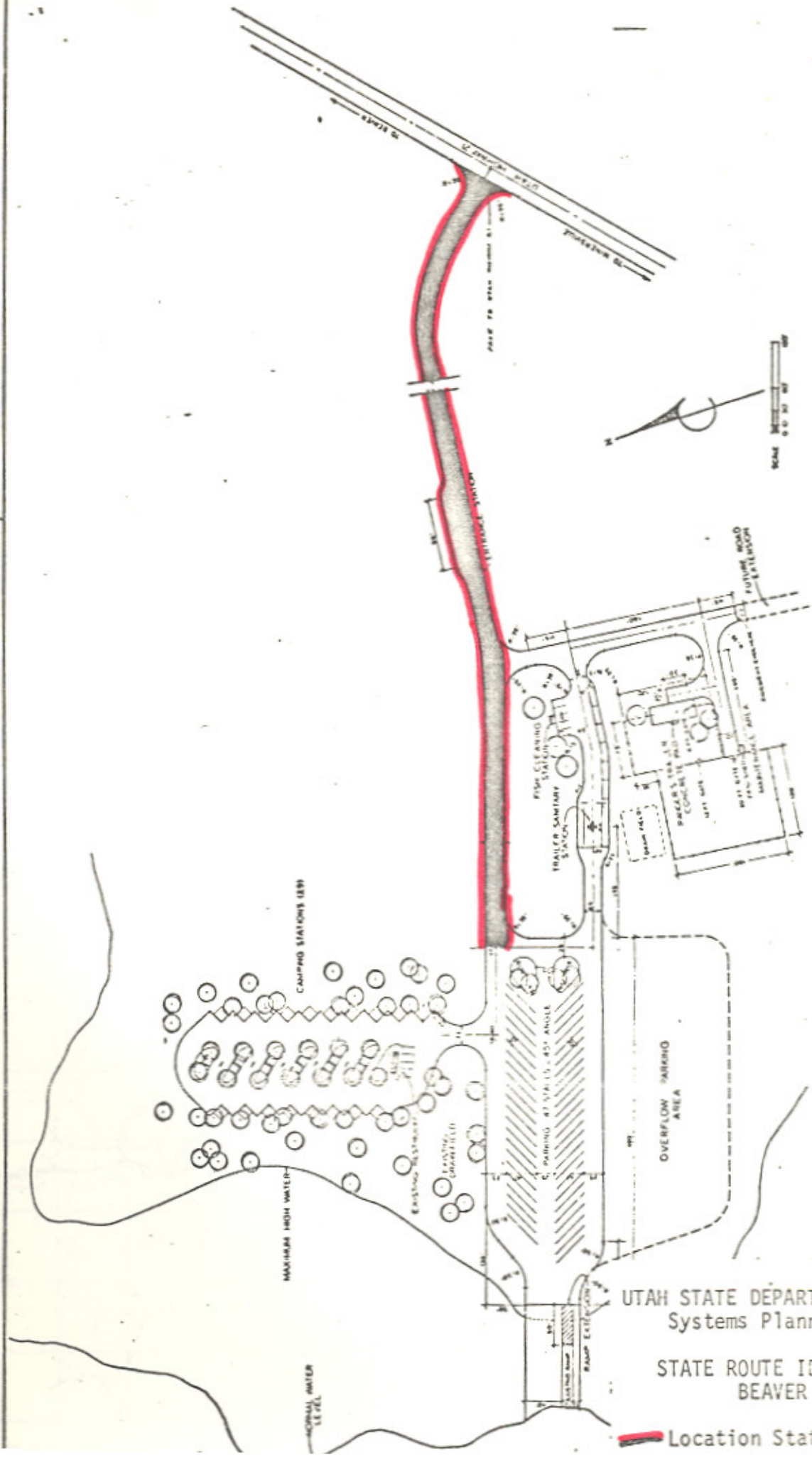

UTAH STATE DEPARTMENT OF HIGHWAYS
Systems Planning Division

STATE ROUTE IDENTIFICATION
BEAVER COUNTY

 Location State Route 310

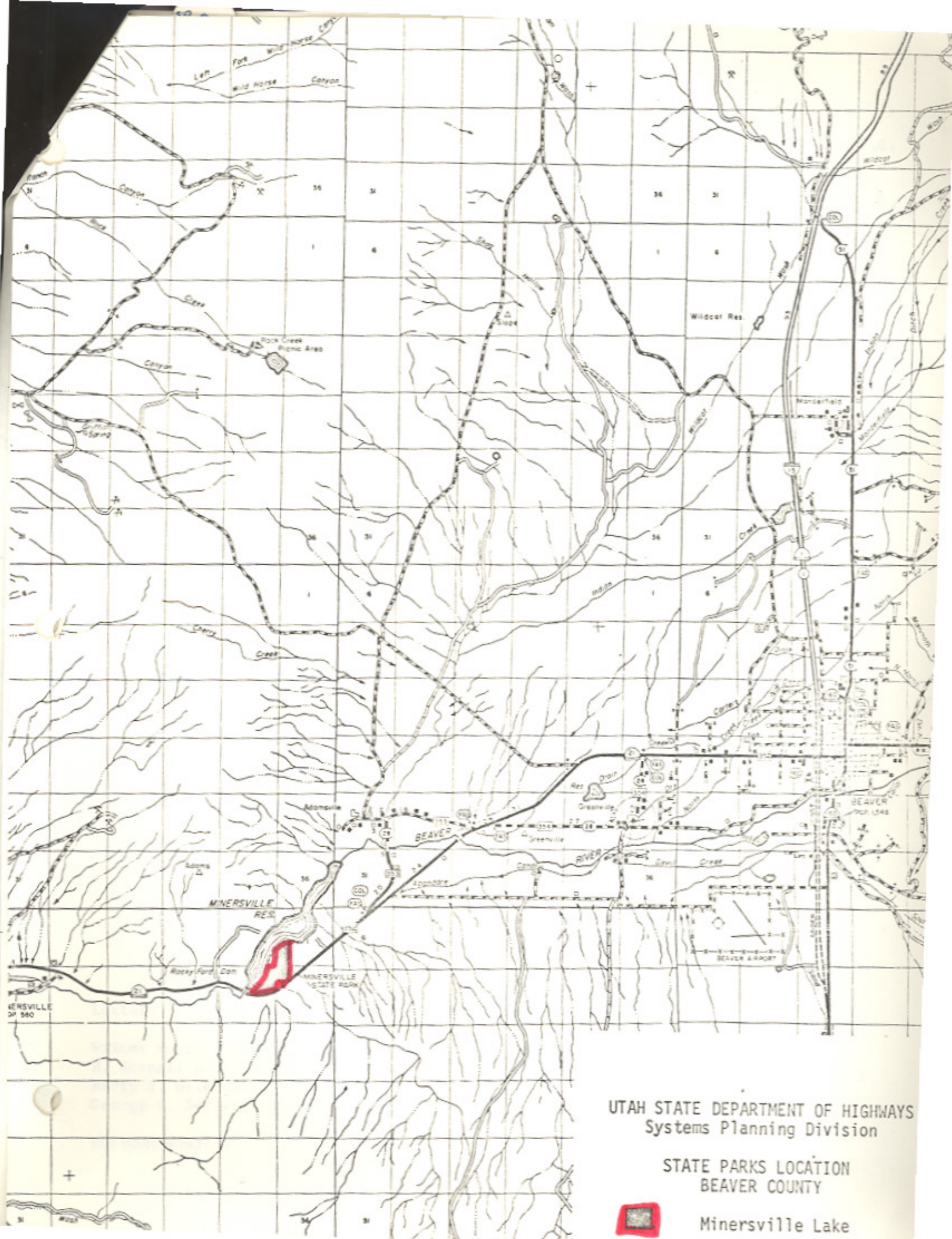

UTAH STATE DEPARTMENT OF HIGHWAYS
Systems Planning Division

STATE PARKS LOCATION
BEAVER COUNTY



Minersville Lake

UTAH STATE DEPARTMENT OF HIGHWAYS

bc: Howard B. Leatham, Engineer for Planning & Programming

Same letter sent to: Mr. Norman V. Hancock, Chief, Game Management Sec., S.L.C.

Information sent to: District Engineers #1 Bert Taylor, #3 William D. Hurley,
District #4 James Deaton, #5 C. V. Anderson, #6 Edwin Lovelace

| | | | |
|-------------------|-------------------|----------------|-------------------|
| Jerry Fenn | Maurice RiChey | Ellen Wandell | Charles Bertolina |
| Ralph Murdock | Clarence Stephens | Harold Brown | Jim West |
| Dean Steed | Evelyn Crill | Ray Behling | Don Jensen |
| Porter M. Gooch | Wallace Liddle | Bonnie Garcia | Clarence Bywater |
| Keith Rosevear | David Sargent | John W. Homer | Ken Riddle |
| Robert Walsh | David Kennison | Chauncey Powis | Winston Neiman |
| Lillian Witkowski | Robin Hood | E. Paul Gilgen | Robert Weadon |
| Mary Decker | Ezra Christensen | Bert Kros | Steve Lawson |
| Howard Richardson | | | |

August 4, 1972

Mr. Harold J. Tippetts, Director
Parks and Recreation Division
1596 West North Temple Street
Salt Lake City, Utah 84104

Dear Mr. Tippetts:

Subject: State Park Roads 305, 306, 307, 308, 309, 310, 311 and 312
in Utah

Effective July 28, 1972, the State Road Commission of Utah adopted resolutions to identify those roadways described in the attached resolutions as a part of the State System of Highways.

Attached are copies of the resolutions and location maps.

Very truly yours,

L. R. Jester, P.E.
Chief, Systems Planning Div.

Attachment

Letters pertaining to routes within their county were sent to:

Wilmer Murray, Duchesne County
H. Bernell Lewis, Kane County
Harry J. Wilkinson, Morgan County
George R. Jefferson, Beaver County

Gardell Snow, Emery County
M. Truman Bowler, Washington County
Don E. Chase, Box Elder County

BDB:WDM:RDent:bt